

Barwick & Associates, LLC

Commercial Real Estate Development
and Investment

Fullwood Commons - Matthews, NC

This \$4 million dollar, 27,000 square foot mixed-used development is located on Matthews-Mint Hill Road, near Highway 74, in Matthews, NC. The project incorporates for lease retail and for sale office condominium units. The design creates a unique sense of identity and a strong retail presence at the street. The signature corner tower element incorporates colored glass that is internally illuminated at night to draw attention to the development. The office buildings were designed to be built in phases, as the tenants' needs develop.

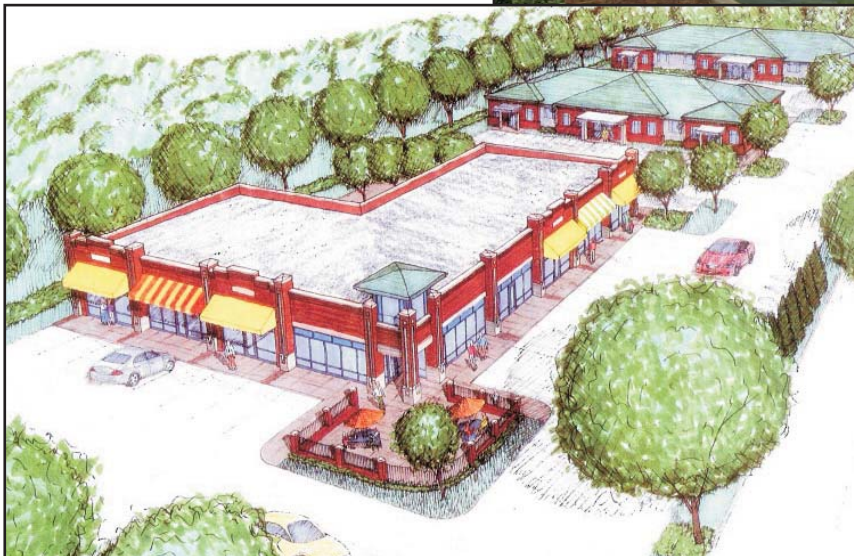

Architect:
Insight Architects - Charlotte, NC
General Contractor:
Cox & Schepp Construction - Charlotte, NC